



**Instructions de montage**  
**Istruzioni di montaggio**  
**Montage-instructie**



**Montage** - Fixations  
**Montaggio** - Graffe  
**Montage** - Klemmen

Fixation 2150 après montage des tubes

Graffa 2150 dopo la posa dei tubi

Klem 2150, voor montage na de buisverlegging t.b.v. buis tot  $\varnothing 22$  mm

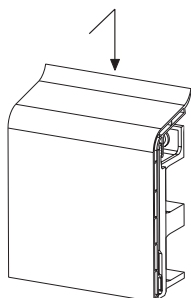
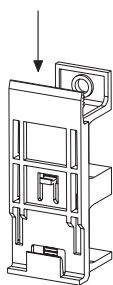
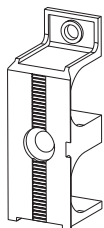
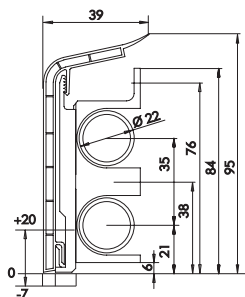

Fixation 2250 avant montage des tubes

Graffa 2250 prima della posa dei tubi

Klem 2250, voor montage voor de buisverlegging t.b.v. buis tot  $\varnothing 22$  mm

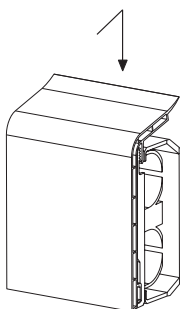
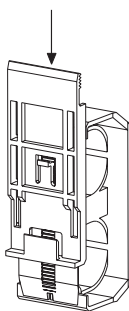
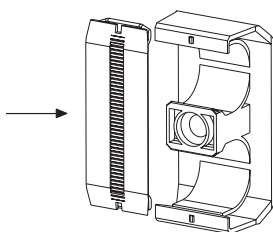
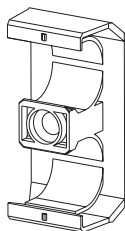
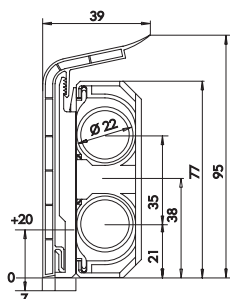

Fixation 2450 pour des tubes jusqu'à  $\varnothing 28$  mm

Graffa 2450 per tubi fino a  $\varnothing 28$  mm

Klem 2450, voor montage voor de buisverlegging t.b.v. buis tot  $\varnothing 28$  mm

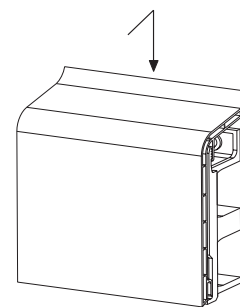
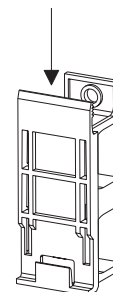
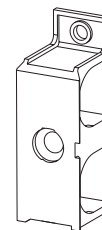
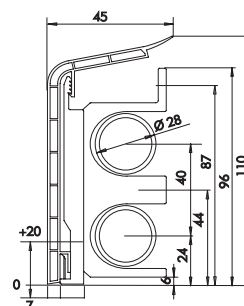

Fixation angle intérieur 2151  
 Graffa angolo interno 2151  
 Binnenhoekklem 2151

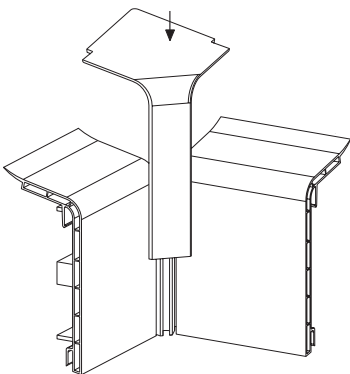
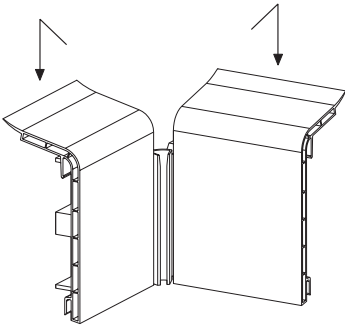
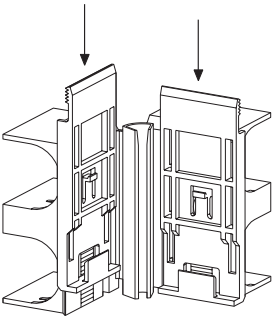
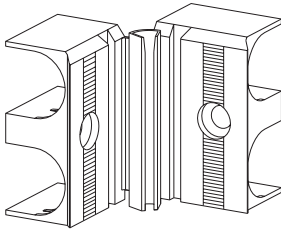
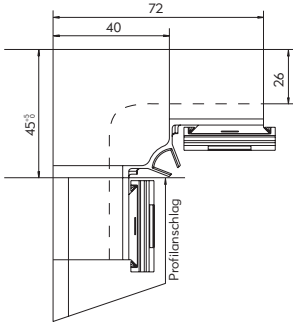

Fixation angle extérieur 2152  
 Graffa angolo esterno 2152  
 Buitenhoekklem 2152

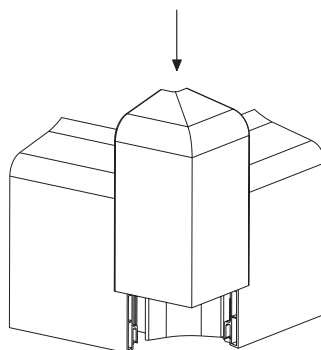
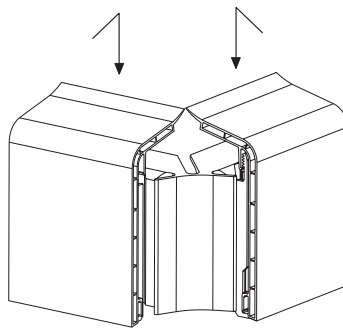
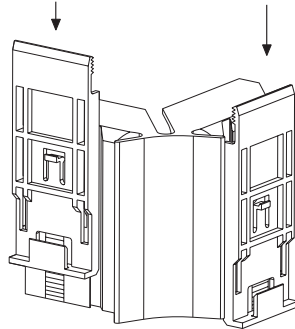
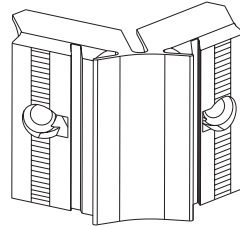
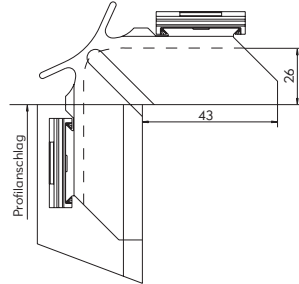

**Montage**  
 Fixations angulaires

**Montaggio**  
 angolari

**Montage**  
 Hoekklemmen

Utiliser les fixations comme calibre de perçage!  
 Usare le graffe come dima per forare!  
 Klemmen als boormal gebruiken



**Montage - Plinthes**

**Montaggio - Zoccolino**

**Montage - Plintprofielen**

Plinthes en synthétique pour des tubes jusqu'à Ø 22 mm

Zoccolino in plastica per tubi fino a 22 mm

Kunststofplintprofiel voor buis tot Ø 22 mm

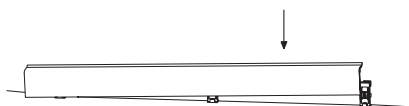
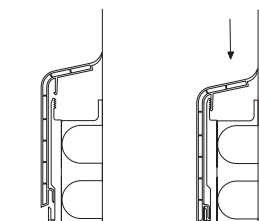
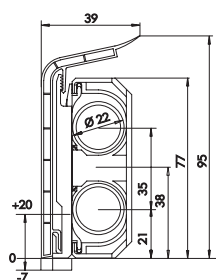

Avec fixation angle intérieur  
Con graffa angolo interno  
Met binnenhoekklem

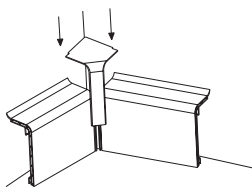

Avec fixation angle extérieur  
Con graffa angolo esterno  
Met buitenhoekklem

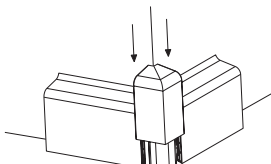

Angles pour des situations particulières

Angoli per casi particolari

Hoeken voor bijzondere verbindingen

Sans fixation angle intérieur \*  
Senza graffa angolo interno  
Zonder binnenhoekklem

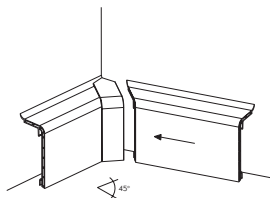

Sans fixation angle extérieur \*  
Senza graffa angolo esterno  
Zonder buitenhoekklem

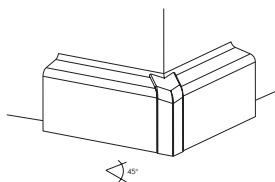

Plinthes pour tapis plein pour des tubes jusqu'à Ø 22 mm

Zoccolino moquettabile per tubi fino a Ø 22 mm

Plintprofiel voor tapijt voor buis tot Ø 22 mm

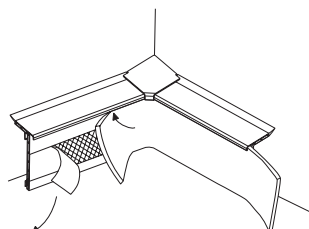
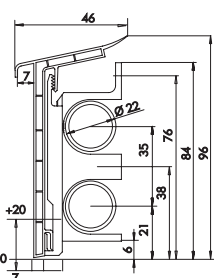

Montage avec des fixations angulaires ou pour des situations particulières comme décrit à gauche et à droite

Montaggio con graffe ad angolo casi particolari come descritto a sinistra e sopra

Montage met hoekklemmen of bijzondere verbindingen zoals in de linkerkolom en boven beschreven

Profilé pour conduite de câble électrique ou 3ième tube

Zoccolino per canalina elettrica per cavo o terzo tubo

Profiel voor inzet kabelkanaal of 3<sup>e</sup> buis

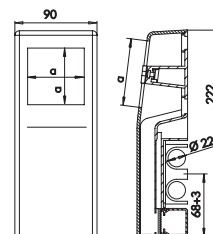
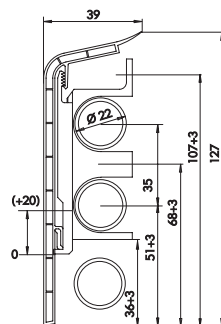

| Type      | Réf.     | Fenêtre pour prise |
|-----------|----------|--------------------|
| Tipo      | Art. n.  | Dim.apertura       |
| Type      | Art. nr. | Uitsparing         |
| SDC 62-62 | 331      | 62 x 62 mm         |
| SDC 73-73 | 332      | 73 x 73 mm         |

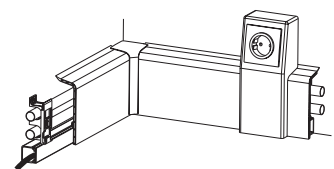
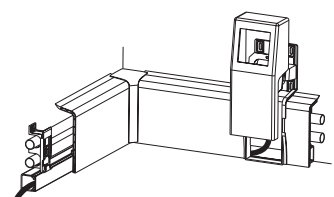
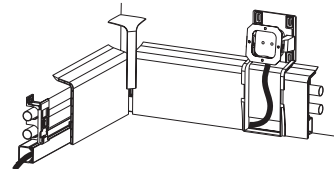
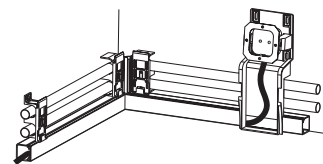
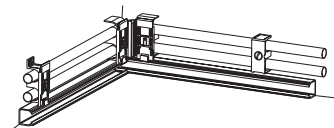

Plinthe en bois massif pour des tubes jusqu'à Ø 18 mm

Zoccolino in legno massiccio per tubi fino a Ø 18 mm

Plintprofil uit massief hout voor buis tot Ø 18 mm

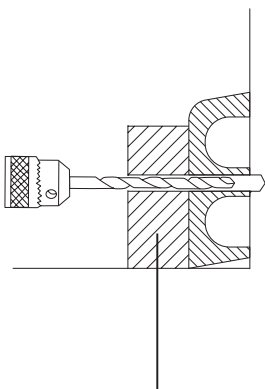
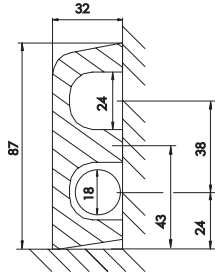

Calibre de perçage  
Mascherina per forare  
Boormal

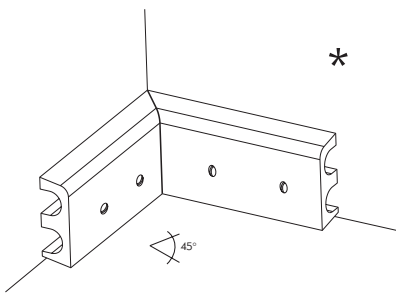

Plinthe de finition en synthétique  
Battiscopa cieco in plastica  
Volle plint uit kunststof

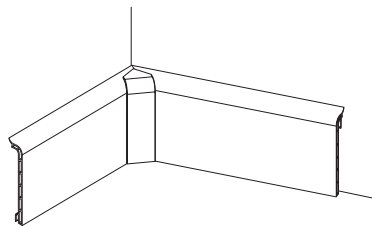
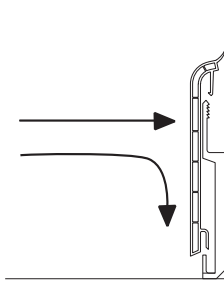
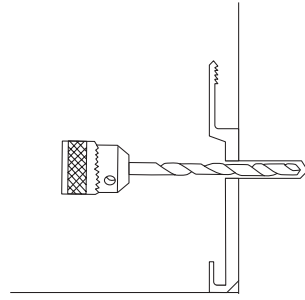
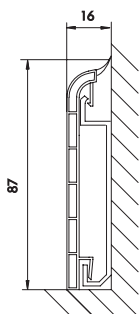

Plinthe de finition en synthétique pour tapis plein  
Battiscopa cieco in plastica moquettabile

Volle plint uit kunststof voor tapijt

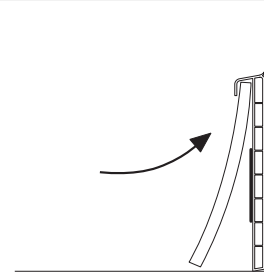
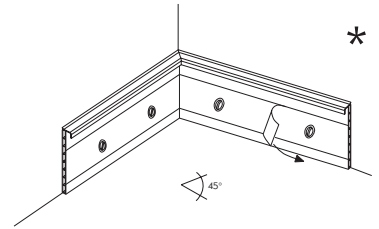
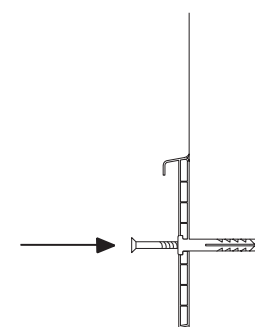
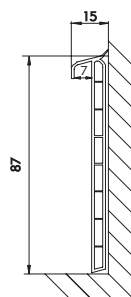

Plinthe de finition en bois massif

Battiscopa cieco in legno  
Volle plint uit massief hout

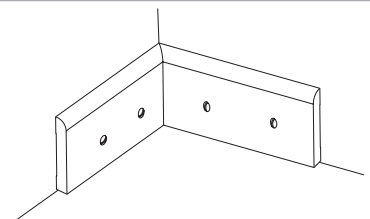
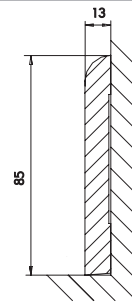

Jonction de plinthe à plinthe de finition

Raccordo tra zoccolino e battiscopa cieco

Overgangsstuk plintprofiel op volle plint

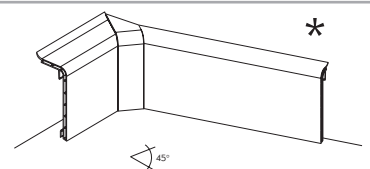
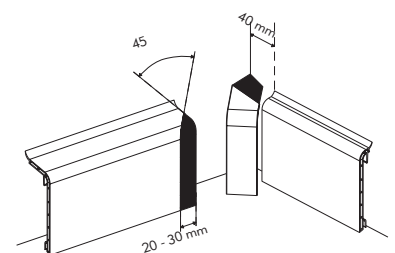

\* = Coupe de biais - Tagli obliqui - Onder verstek zagen



## Montage

Raccords pour radiateurs, raccords couvés

## Montaggio

Curvette e detentori ad angolo

## Montage

Radiatoraansluitingen, Instelbare hoek - en pasbogaansluiting

Raccord pour radiateur en une pièce (à souder)

Allacciamenti per corpi scaldanti in un pezzo unico (a saldare)

Radiatoraansluitingen één delig (solderen)

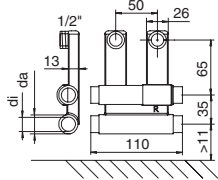

| Ref. art. n. | di       | da       | Valve     |
|--------------|----------|----------|-----------|
| art. nr.     | di       | de       | Valvola   |
|              | bi. dia. | bu. dia. | ventiela. |
| 1315L        | 15       | 18       | ←         |
| 1318L        | 18       | 22       | ←         |
| 1315R        | 15       | 18       | →         |
| 1318R        | 18       | 22       | →         |

← gauche - a sinistra - links  
→ droite - a destra - rechts

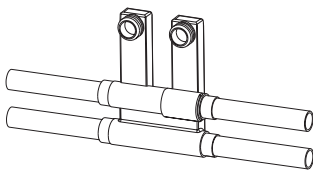

Raccord pour radiateur en deux pièces (à souder, sertir, visser) \*

Allacciamenti per corpi scaldanti in due pezzi (a saldare, a pressare, a stringere)

Radiatoraansluitingen tweedelig (solderen, persen en knellen)

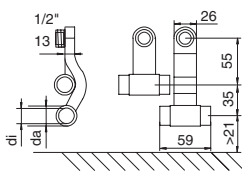

| Ref. art. n. | di       | da       |
|--------------|----------|----------|
| art. nr.     | bi. dia. | bu. dia. |
| 1015         | 15       | 18       |
| 1018         | 18       | 22       |

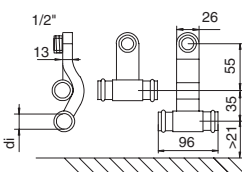

| Ref. art. n. | di          |
|--------------|-------------|
| art. nr.     | binnen dia. |
| 1515         | 15          |
| 1518         | 18          |

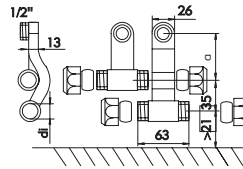

| Ref. art. n. | di       | a   |
|--------------|----------|-----|
| art. nr.     | bi. dia. | a   |
| 1115         | 15       | 55  |
| 1118         | 18       | 55  |
| 2115         | 15       | 107 |
| 2118         | 18       | 107 |

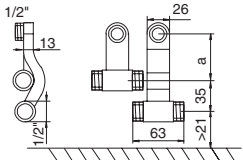

| Ref. art. n. | di       | a   |
|--------------|----------|-----|
| art. nr.     | bi. dia. | a   |
| 1215         | 1/2"     | 55  |
| 2215         | 1/2"     | 107 |

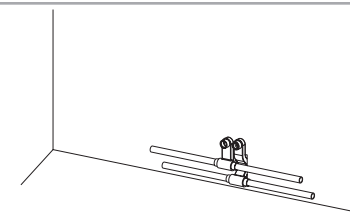
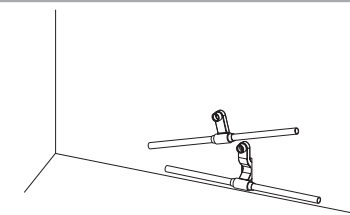
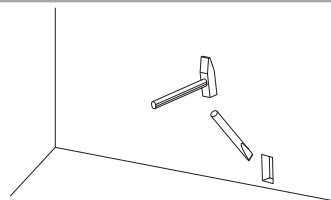

Raccord à vanne coudée / raccord couvé \*

Coppia detentori cromati ad angolo / coppia detentori ad angolo

Instelbare hoek - en pasbogaansluiting

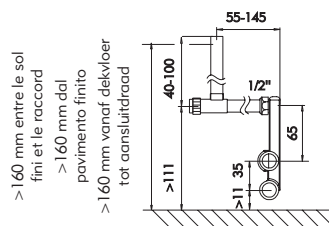

Déterminer l'hauteur et la profondeur, raccourcir, monter à l'aide des raccords à compression

Aggiustare l'altezza e profondità; tagliare; montare con l'anello a compressione

Hoogte en diepte vaststellen; op maat maken en met klemringverbinding vastmaken

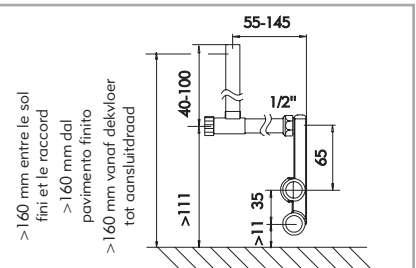

>160 mm entre le sol fini et le raccord  
>160 mm dal pavimento finito tot aansluitdraad

min. 160 mm entre le sol fini et le raccord  
min. 160 mm dal pavimento finito tot aansluitdraad

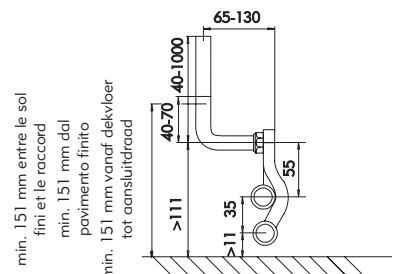

min. 151 mm entre le sol fini et le raccord  
min. 151 mm dal pavimento finito tot aansluitdraad

Hauteur minimale  
Altezza minima  
min. hoogte = 40 mm

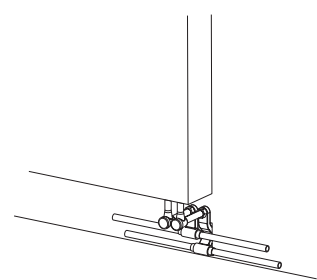
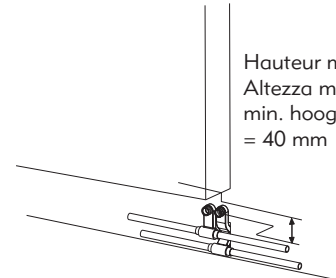

Profilé montant synthétique  
en forme de U

Copritraccia per colonne  
montanti forma ad „U”

Kunststofstijprofiel uit  
kunststof U-vorm

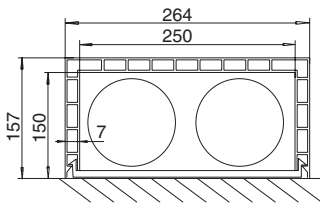
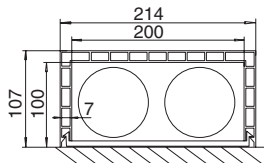
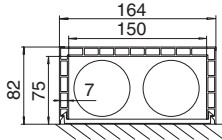
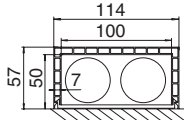

Profilé montant synthétique  
en forme de L

Copritraccia per colonne  
montanti forma ad „L”

Kunststofstijprofiel uit  
kunststof L-vorm

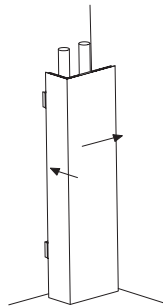
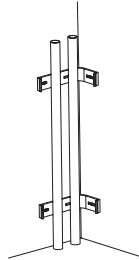
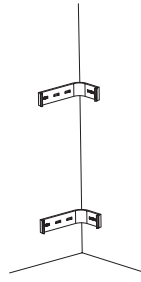
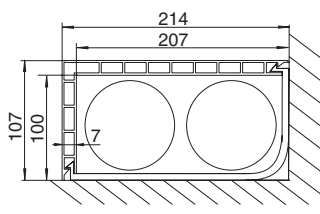
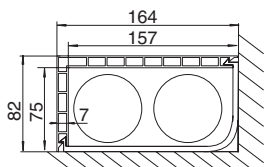

Profilé montant synthétique  
en forme de L (6480)

Copritraccia per colonne  
montanti forma ad „L” (6480)

Kunststofstijprofiel uit  
kunststof L-vorm (6480)

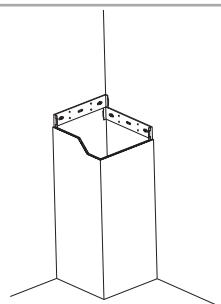
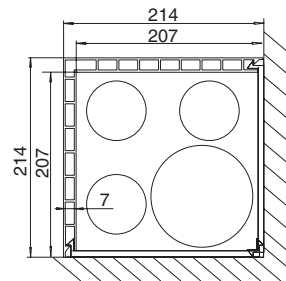

**Montage**  
Profilé montant  
synthétique en forme de U / L

**Montaggio**  
Copritraccia a U / L

**Montage**  
Kunststofstijprofiel uit  
kunststof U-vorm / L-vorm

Accessoires pour profilés montants

Accessori per copritraccia

Toebehoren voor stijprofiel

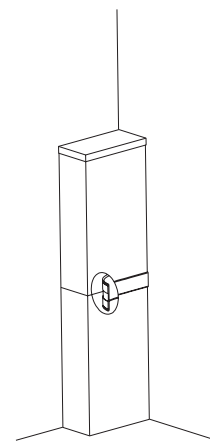
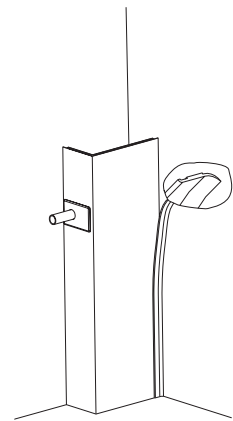

# Aperçu Panoramica Overzicht

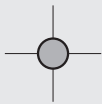

Possible, disponible, à combiner  
possibile, disponibile, adatto  
mogelijk, aanwezig, passend

Plinthe synthétique pour tubes jusqu'à 22 mm  
Zoccolino in plastica per tubi fino a 22 mm  
Kunststofplinthoef voor buizen tot 22 mm

Plinthe pour tapis plein pour tubes jusqu'à 22 mm  
Zoccolino moquette/ble per tubi fino a 22 mm  
Tapijplinthoef voor buizen tot 22 mm

Profilé pour canal de câble électrique ou 3 . tube  
Profilo per canale passacavi o 3° tubo  
Kunststofplinthoef voor buizen tot 22 mm

Plinthe synthétique pour tubes jusqu'à 28 mm  
Zoccolino in plastica per tubi fino a 28 mm  
Kunststofplinthoef voor buizen tot 28 mm

Plinthe en bois massif pour tubes jusqu'à 18 mm  
Zoccolino in legno per tubi fino a 18 mm  
Volle plint van hout voor buizen tot 18 mm

Plinthe synthétique de finition  
Battiscopa cieco in plastica  
Volle plint van kunststof

Plinthe de finition pour tapis plein  
Battiscopa cieco moquette/ble  
Volle plint van kunststof voor tapijt

Plinthe de finition en bois massif  
Battiscopa cieco in legno  
Volle plint van hout

|   |   |   |   |   |   |   |   |   |
|---|---|---|---|---|---|---|---|---|
| Érable, hêtre clair et foncé, frêne blanc, chêne foncé<br>Acero, faggio chiaro e scuro, frassino bianco, rovere scuro<br>Ahorn, licht en donker beuken, wit essen, donker eiken | ● |   |   |   |   | ● |   |   |
| Chêne clair, blanc<br>Rovere chiaro, bianco<br>Licht eiken, wit   | ● | ● | ● | ● |   | ● | ● |   |
| Gris<br>Grigio<br>Grijs   | ● |   | ● |   |   | ● |   |   |
| Fixation 2150, 2250<br>Graffa 2150, 2250<br>Klem 2150, 2250   | ● | ● | ● |   |   |   |   |   |
| Fixation 2450<br>Graffa 2450<br>Klem 2450   |   |   |   | ● |   |   |   |   |
| Fixation angle intérieur 2151, fixation angle extérieur 2152<br>Graffa angolo interno 2151, Graffa angolo esterno 2152<br>Binnenhoekklem 2151, buitenhoekklem 2152              | ● | ● | ● |   |   |   |   |   |
| Porte-plinthes<br>Graffa 155<br>Plinthouder voor volle plint  |   |   |   |   |   | ● |   |   |
| Fixation avec cheville à clouer ou vis à tête lentiforme<br>Fissaggio tramite tassello con vite<br>Bevestiging met plug of kruiskopschroef                                      |   |   |   |   | ● |   | ● | ● |
| Angle intérieur et extérieur pour fixation angulaire<br>Angolo interno ed esterno per graffe ad angolo<br>Binnen- en buitenhoek voor klemmen                                    | ● | ● | ● |   |   |   |   |   |
| Angle intérieur et extérieur pour situations particulières<br>Angolo interno ed esterno per soluzioni particolari<br>Binnen- en buitenhoek voor speciale toepassingen           | ● | ● | ● | ● |   | ● |   |   |
| Raccord<br>Coprigiunto<br>Stootverbinder  | ● | ● | ● | ● |   | ● |   |   |
| Pièce de finition<br>Terminale<br>Eindstuk  | ● | ● | ● | ● | ● | ● |   |   |
| Prévu pour les raccords de radiateurs HZ<br>Adatto ad allacciamento HZ<br>Passend voor HZ radiatoraansluitsysteem   | ● | ● | ● | ● |   |   |   |   |
| Ruban de jonction mural<br>Labbro morbido a parete<br>Dichtingslip aan de muur  | ● | ● | ● | ● |   | ● | ● |   |
| Prévu pour boîte électrique<br>Contentitore per presa elettrica<br>Stekkerdooscontainer   |   |   | ● |   |   |   |   |   |

Votre fournisseur:  
Distributore:  
Uw leverancier:

Hans Weitzel KG  
Konrad-Adenauer-Straße 20  
D-55218 Ingelheim



www.hz-weitzel.de  
export@hz-weitzel.de

Telefon +49 (0) 6132 / 790 89 -10  
Telefax +49 (0) 6132 / 7836 -10